



**Electrical performance:**  
CEI EN 50393 with connectors  
complying with EN 61238-1  
(with testing under water head  
and water between the cable cores)  
Class 2 in accordance with CEI 64-8.

**No flame propagation:**  
CEI 20-35 • IEC 60332-1 HD405-1  
(as applicable)

Operating temperature  90°

Installation temperature:  -15°C / +45°C

# Heat-shrink

Straight or branch heat-shrinkable joints  
for extruded insulation cables up to a 1 kV.

## Installation sequence

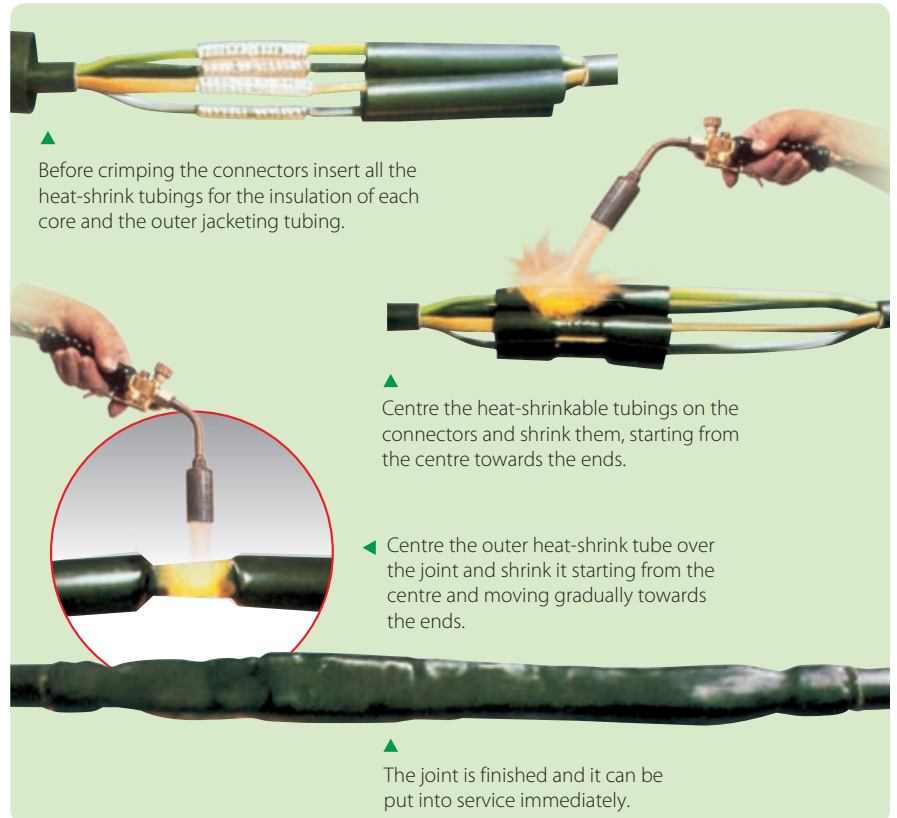



## GDL

Joint for single core cables including concentric neutral.

Product	Conductor cross section mm <sup>2</sup>		Dimensions L (mm)
	from	to	
GDL 92 A1	4	10	300
GDL 92 A2	16	150	300
GDL 92 A3	185	400	300
GDL 92 PA	10	50	300

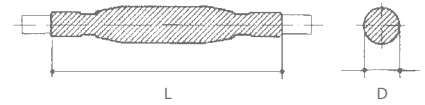

## GLV

Joint for multi core cables (also for submersible pumps).

Product	Conductor cross section mm <sup>2</sup>		Number of phases	Dimensions L (mm) D (mm)	
	from	to		L (mm)	D (mm)
GLV 0306	1,5	6	3	250	18
GLV 0316	10	16	3	400	37
GLV 0335	25	35	3	550	43
GLV 0370	50	70	3	650	52
GLV 3150	95	150	3	800	65
GLV 3300	185	300	3	900	82
GLV 0406	1,5	6	4	250	20
GLV 0416	10	16	4	400	40
GLV 0435	25	35	4	650	45
GLV 0470	50	70	4	650	54
GLV 4150	95	150	4	800	67
GLV 4300	185	300	4	900	84
GLV 2,5 - CP	2,5 complete with connectors		4	300	15

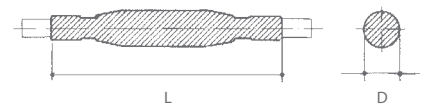

For both copper and aluminium cables. For aerial, underground, submerged installation.

## GLV-N

Joint for multi core cables with concentric neutral.

Product	Conductor cross section mm <sup>2</sup>		Number of phases	Dimensions L (mm) D (mm)	
	from	to		L (mm)	D (mm)
GLV 0306 - N	1,5	6	3	250	18
GLV 0316 - N	10	16	3	400	37
GLV 0335 - N	25	35	3	550	43
GLV 0370 - N	50	70	3	650	52
GLV 3150 - N	95	150	3	800	65
GLV 3300 - N	185	300	3	900	82
GLV 0406 - N	1,5	6	4	250	20
GLV 0416 - N	10	16	4	400	40
GLV 0435 - N	25	35	4	650	45
GLV 0470 - N	50	70	4	650	54
GLV 4150 - N	95	150	4	800	67
GLV 4300 - N	185	300	4	900	84

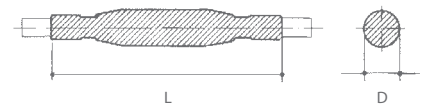

These kits include components for the phase insulation, metallic braiding to replace the neutral and external self-sealing heat-shrinkable tube.

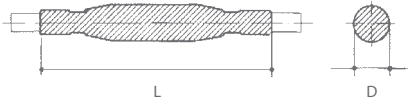

## GLV-ARM

Joint for armoured multi core cables.

Product	Conductor cross section (mm <sup>2</sup> )		Dimensions	
	from	to	L (mm)	D (mm)
GLV 0406-ARM	1,5	6	300	25
GLV 0416-ARM	6	16	400	40
GLV 0450-ARM	25	50	800	60
GLV 4150-ARM	70	150	1000	100
GLV 4300-ARM	185	300	1000	120

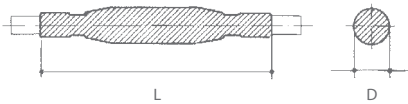

## BOPA

Joint for MV cables for public lighting.

Product	Operating voltage kV	Number of phases	Section (mm <sup>2</sup> )	Dimensions	
				L (mm)	D (mm)
BOPA 3	3	1	1x10	300	50
BOPA 4	3	2	2x10	450	60
BOPA 5	3	3	3x10	450	70
BOPA 3/2	3,6	1 + concentric neutral	1 x 6 + 6 concentric	700	35
BOPA 4/T transition	3	2	2,5 - 10 paper / 10 - 50 extruded	750	40

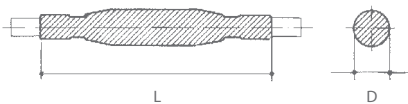

## DJ

LV branch joint.

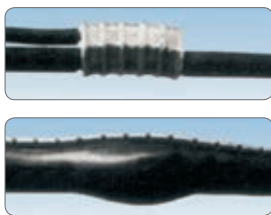

Product	Single core cables cross section (mm <sup>2</sup> )		Multi core cables cross section (mm <sup>2</sup> )		Dimensions	
	Through	Branch	Through	Branch	L (mm)	D (mm)
DJ01	1 x 4 - 50	1 x 2,5 - 50	4 x 1,5 - 10	2 x 1,5	200	25
DJ02	1 x 50 - 120	1 x 6 - 120	4 x 16 - 25 2 single core cables	2x1,5 1 two core cable	250	40
DJ03	1 x 150 - 300	1 x 6 - 300	4 x 25 - 3,5 x 50	4 x 2,5 - 25	400	70



**Ray Tech**

## GLV System Fast RP

Straight joint + Shear bolt connectors.

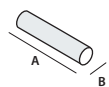

Product	Cable formation 4x (n° x mm <sup>2</sup> )	Dimensions A x B (mm)
GLV 0435- RP/16	6 - 16	650 x 50
GLV 0470- RP/35	25 - 35	650 x 70
GLV 0470- RP/50	25 - 50	650 x 75
GLV 4150- RP/150	50 - 150	800 x 80

## GLV F/R - GMP F/R

Joint for fire resistant cables (0,6/1 kV).

FOR NAVAL TYPE POWER CABLES

UNARMOURED			ARMOURED		
Product	Cable formation (n° x mm <sup>2</sup> )	L (mm)	Product	Cable formation (n° x mm <sup>2</sup> )	L (mm)
GLV 4004-F/R	4 x 1,5 - 4	300	GLV 4004-ARM-F/R	4 x 1,5 - 4	400
GLV 4016-F/R	4 x 6 - 16	300	GLV 4016-ARM-F/R	4 x 6 - 16	400
GLV 4050-F/R	4 x 25 - 50	400	GLV 4050-ARM-F/R	4 x 25 - 50	500
GLV 4150-F/R	4 x 70 - 150	500	GLV 4150-ARM-F/R	4 x 70 - 150	750

FOR NAVAL TYPE SIGNALLING AND CONTROL CABLES

UNARMOURED			ARMOURED		
Product	Cable formation (n° x mm <sup>2</sup> )	L (mm)	Product	Cable formation (n° x mm <sup>2</sup> )	L (mm)
GMP 007-F/R	4 - 7 x 1,5 - 2,5	300	GMP 007-ARM-F/R	4 - 7 x 1,5 - 2,5	400
GMP 014-F/R	10 - 14 x 1,5 - 2,5	300	GMP 014-ARM-F/R	10 - 14 x 1,5 - 2,5	400
GMP 030-F/R	16 - 30 x 1,5 - 2,5	400	GMP 030-ARM-F/R	16 - 30 x 1,5 - 2,5	500

FOR UNDERGROUND POWER CABLES

UNARMOURED			ARMOURED		
Product	Cable formation (n° x mm <sup>2</sup> )	L (mm)	Product	Cable formation (n° x mm <sup>2</sup> )	L (mm)
GLV 4006-F/R-G7	4 x 1,5 - 6	300	GLV 4006-ARM-F/R-G7	4 x 1,5 - 6	400
GLV 4016-F/R-G7	4 x 6 - 16	300	GLV 4016-ARM-F/R-G7	4 x 6 - 16	400
GLV 4050-F/R-G7	4 x 25 - 50	400	GLV 4050-ARM-F/R-G7	4 x 25 - 50	500
GLV 4150-F/R-G7	4 x 70 - 150	500	GLV 4150-ARM-F/R-G7	4 x 70 - 150	750

FOR UNDERGROUND SIGNALLING AND CONTROL CABLES

UNARMOURED			ARMOURED		
Product	Cable formation (n° x mm <sup>2</sup> )	L (mm)	Product	Cable formation (n° x mm <sup>2</sup> )	L (mm)
GMP 014-F/R-G7	Fino a 14 x 1,5 - 2,5	300	GMP 014-ARM-F/R-G7	Fino a 14 x 1,5 - 2,5	400
GMP 019-F/R-G7	Fino a 19 x 1,5 - 2,5	400	GMP 019-ARM-F/R-G7	Fino a 19 x 1,5 - 2,5	500

## DJ F/R

Branch joint for fire resistant cables (0,6/1 kV).

FOR POWER CABLES

UNARMOURED		ARMOURED		L (mm)
Product	Product	Cable formation (n° x mm <sup>2</sup> )		
DJ 4016 - F/R	DJ 4016 - ARM-F/R	Through	Branch	300
		3 - 4 x 1,5 - 16	3 - 4 x 1,5 - 16	

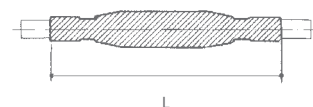

### Prestazioni elettriche:

CEI EN 50393 con connettori a norma EN 61238-1 (con prova sotto battente d'acqua e acqua tra le anime del cavo) in classe 2 secondo la norma CEI 64-8

### Resistenza alla fiamma:

IEC 60331-21 • CEI 20-36/2-1 (per quanto applicabili)

Per altre formazioni e sezioni di cavo contattare Raytech.

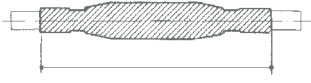

## GMP

Joint kits for multi conductor cables for signalling, command and control.

NON ARMoured cable		N° of conductors		Section mm <sup>2</sup>		External Ø of cable	
Product	from	to	from	to	min (mm)	max (mm)	
GMP 007	4	7	1,0	2,5	8	19	
GMP 014	8	14	1,0	2,5	12	22	
GMP 021	15	21	1,0	2,5	15	27	
GMP 040	22	40	1,0	2,5	20	35	
GMP 075	41	75	1,0	2,5	26	44	
GMP 100	76	100	1,0	2,5	26	60	

ARMoured cable		N° of conductors		Section mm <sup>2</sup>		External Ø of cable	
Product	from	to	from	to	min (mm)	max (mm)	
GMP 007-A	4	7	1,0	2,5	14	23	
GMP 014-A	8	14	1,0	2,5	15	26	
GMP 021-A	15	21	1,0	2,5	24	35	
GMP 040-A	22	40	1,0	2,5	30	45	
GMP 075-A	41	75	1,0	2,5	39	55	

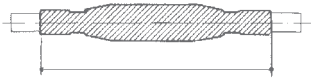

## GMC

Joint kits for multi pair cables for communication, command or control.

NON ARMoured cable		N° of pairs		Section mm <sup>2</sup>		External Ø of cable	
Product	from	to	from	to	min (mm)	max (mm)	
GMC 010	5	10	2 x 0,6	2 x 1,0	9	14	
GMC 020	11	20	2 x 0,6	2 x 1,0	13	20	
GMC 030	21	30	2 x 0,6	2 x 1,0	16	24	
GMC 050	31	50	2 x 0,6	2 x 1,0	22	29	
GMC 100	51	100	2 x 0,6	2 x 1,0	30	40	

ARMoured cable		N° of pairs		Section mm <sup>2</sup>		External Ø of cable	
Product	from	to	from	to	min (mm)	max (mm)	
GMC 004-A	1	4	2 x 0,6	2 x 1,0	15	23	
GMC 007-A	5	7	2 x 0,6	2 x 1,0	15	26	
GMC 019-A	8	19	2 x 0,6	2 x 1,0	24	35	
GMC 037-A	20	37	2 x 0,6	2 x 1,0	30	45	
GMC 061-A	38	61	2 x 0,6	2 x 1,0	39	55	